

NOTES

- Contractors must check all dimensions on site. Only figured dimensions are to be worked from. Discrepancies must be reported to the Architect or Engineer before proceeding. © This drawing is copyright.
- Reproduced from OS Sitemap © by permission of Ordnance Survey on behalf of The Controller of Her Majesty's Stationery Office. © Crown copyright 2008. All rights reserved. Licence number 100007126.



KEY PLAN

SCHEDULE OF AREAS

UNIT 1	
GEA Ground	= 538 m ² / 5791 ft ²
GIA Ground	= 488 m ² / 5253 ft ²
GIA First	= 115 m ² / 1248 ft ²
Total GIA	= 603 m² / 6491 ft²

- Additional Notes:**
- Internal setting out dimensions to grid lines, blockwork/studwork walls and first floor slab structure. For wall linings and finishes refer to Wall Types Plan.

TENDER ISSUE

C	Updated plan & Tender Issue	MA	SA	08/07/2022
B	Updated plans	MA	SA	22/04/2022
A	Updated to suit client comments	CH	CW	30/03/2022
REV	DESCRIPTION	DRN	CHD	DATE
<input type="checkbox"/>	PRELIMINARY	<input type="checkbox"/>	INFORMATION	<input checked="" type="checkbox"/> TENDER
<input type="checkbox"/>	CONSTRUCTION	<input type="checkbox"/>	AS BUILT	

SCALE 1:100 @ A1 DATE 24 MARCH 2022

DRAWN KI CHK SA

DRAWING NO. 18605 - 100 REV C

TITLE **THE CHALKLANDS PHASES III & IV
EASTERN AVENUE, DUNSTABLE**

DETAILS **PROPOSED FLOOR PLANS
UNIT 1**

Woods Hardwick
Architecture | Engineering | Planning | Surveying

BEDFORD : HEAD OFFICE
15-17 Goldington Road
Bedford MK40 3NH
T: +44 (0) 1234 268862

BIRMINGHAM
Fort Dunlop, Fort Parkway
Birmingham B24 9FE
T: +44 (0) 121 6297784

ONLINE: mail@woodshardwick.com | woodshardwick.com

PLEASE CONSIDER THE ENVIRONMENT BEFORE PRINTING THIS DRAWING

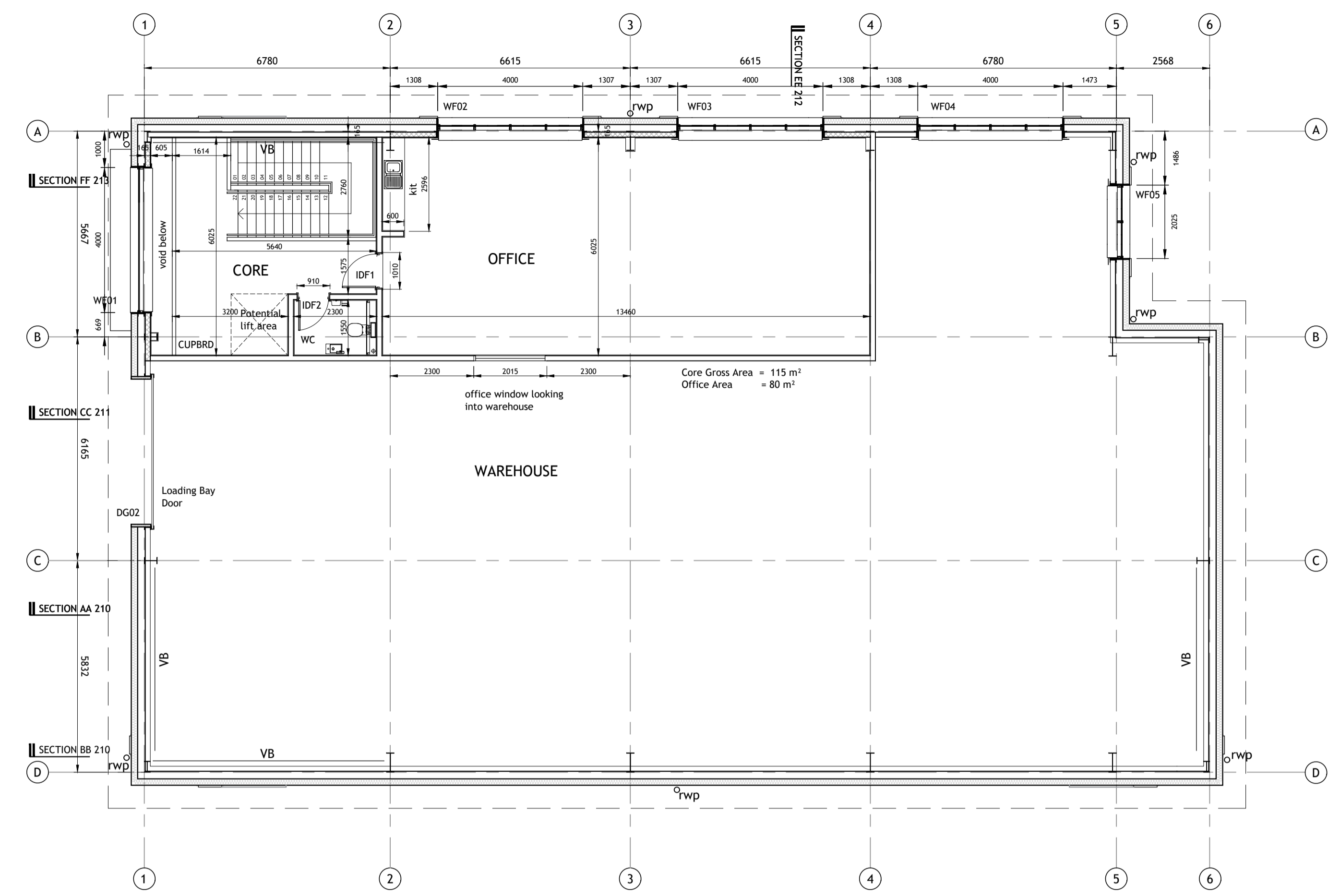

**PROPOSED FIRST FLOOR PLAN - 1:100
UNIT 1**

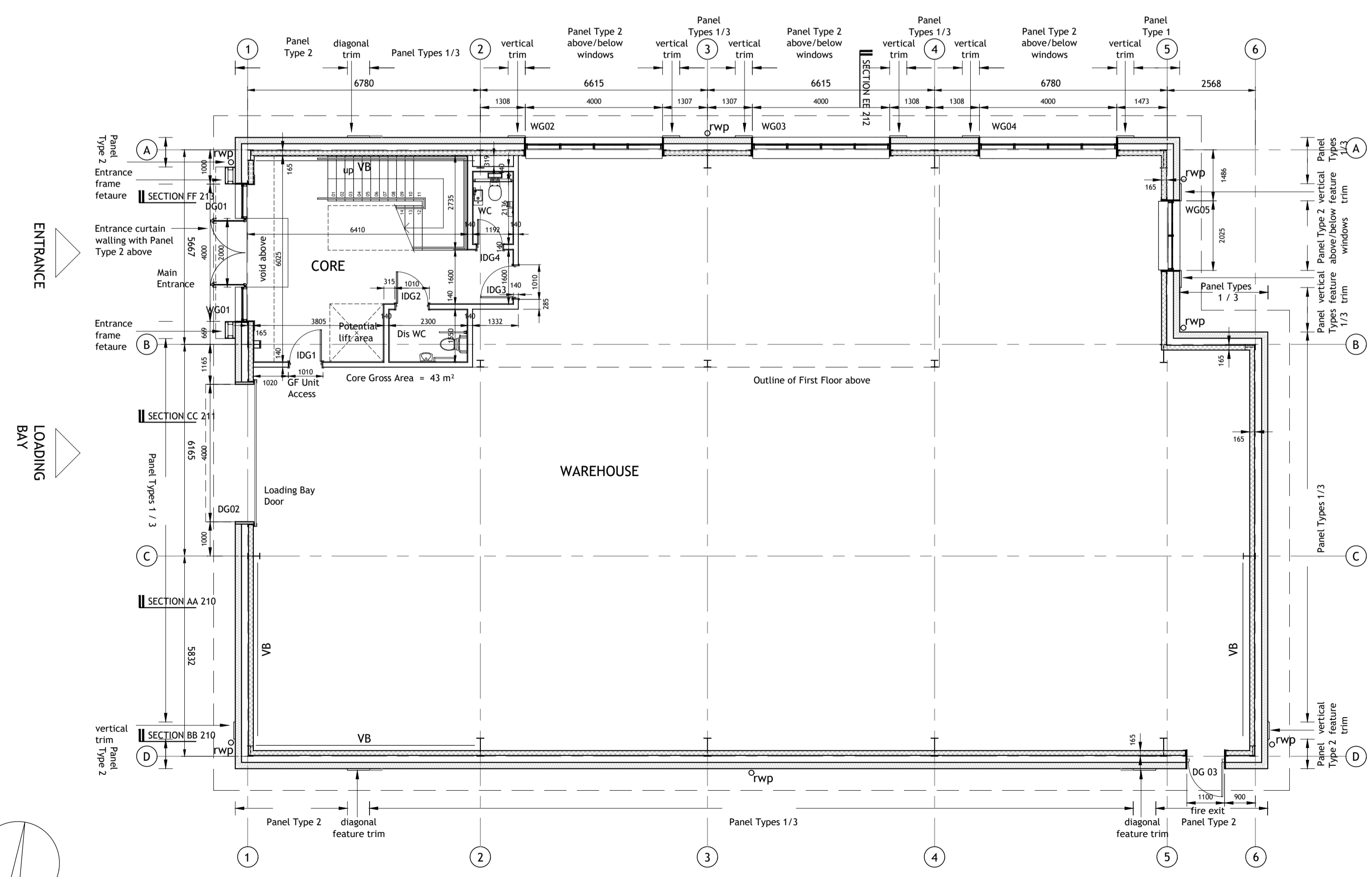

**PROPOSED GROUND FLOOR PLAN - 1:100
UNIT 1**

