



**UNIT 3
Warehouse**
min. 12.0m to u/s haunch

Different Wall Types - refer to drawing W038-S-DR-818

- W1 General Stud Wall - (with Insulation)
- W2 150mm composite wall panel
- W3 150mm composite wall panel (with stud lining)
- W4 Lift shaft precast conc' wall & liner
- W5 Wall Liner
- W6 Column Liner

Mezzanine

Indicative Above Ground Drainage Positions:-
Internal Drainage 'pop-up' locations added as advised on MBA's Drawing: 20-246-M-760

- Drainage Stack
- Drainage Stack from Above
- Rodding Eye
- Floor Gully
- Drainage Pipework

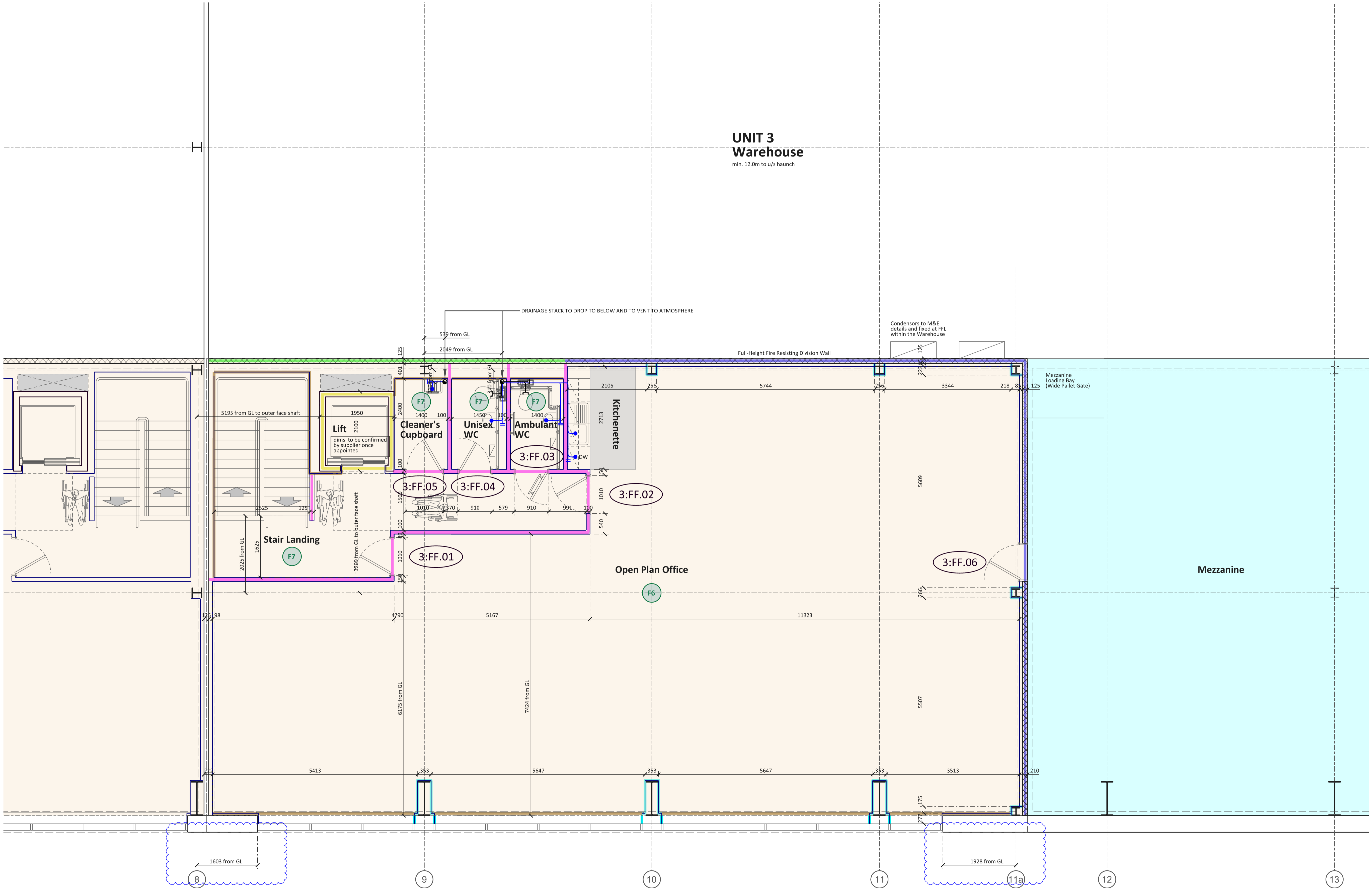

**Unit 3 - First Floor Level
Core/ Office Plan**

Rev C6: Additional Dims added as requested. HM - 11.12.2022
 Rev C5: Access Door added to Mezzanine Floor from Open Plan Office.
 Mezzanine Loading Bay (Wide Pallet Gate) highlighted for Mezzanine.
 HM - 05.12.2022
 Rev C4: Lift Shaft adjusted. PAL - 02.12.2022
 Rev C3: Whitewall Thickness Updated. Internal Drainage 'pop-up'
 locations added as advised on MBA's Drawing: 20-246-M-770. Drainage
 stack positions slightly tweaked to a more suitable location / differs from
 MBA's positioning. Layout to be reviewed with EirEng; Additional Setting
 Out Dims. Added to Stair. HM - 30.11.2022
 Rev C2: Door Numbers adjusted to suit Door Schedule. HM - 20.09.2022
 Rev C1: Construction Issue. HM - 12.08.2022

Drawing Status:
CONSTRUCTION

**CMP
Architects**

Client



Project
Betty Road, Waltham Cross

Title
Unit 3
First Floor Level Core/ Office Plan

Scale 1:50@A1 / 1:100@A3 Drawn HM Date 01.08.2022

Drg. No. W038-U3-DR-151 Revision C6

Do not scale from this drawing, use figured dimensions only. Subject to accurate site survey. All dimensions to be checked and verified for any discrepancies. All drawings to be read in conjunction with all CMP architects and other consultants' contract documentation. Any discrepancies to be reported before any work commences. All items installed by others are to be fully site coordinated and programmed with the Contractor. All products to be installed to manufacturers recommendations.
©Copyright CMP Architects Ltd