



Dagenham Logistics Hub, Rainham Road South, Dagenham, RM108SX

BRAND NEW INDUSTRIAL WAREHOUSE UNITS

Tenure	To Let
Available Size	6,513 to 34,670 sq ft / 605.08 to 3,220.95 sq m
Service Charge	N/A
Business Rates	N/A
EPC Rating	Upon Enquiry

- Available Q3 2023
- BREEAM Excellent
- EPC rating A
- 50 kN sq m
- Eaves height up to 10m

Description

Flexible industrial/ warehouse units with fully fitted first floor office for occupiers to undertake their own fit out to suit their specific occupational needs.

Location

Dagenham benefits from excellent communications being situated between the A12 and A13, the two principal arterial roads east of Central London.

Situated on Rainham Road South at the former Rexel site, Zephyr Park will offer new high quality industrial/warehouse units.

Dagenham East London Underground station is located less than 1km away, along with extensive amenities including a Tesco Express, Costa and a public house.

Accommodation

The accommodation comprises the following areas:

Name	sq ft	sq m	Availability
Unit - 1	34,670	3,220.95	Available
Unit - 2	7,449	692.03	Available
Unit - 3	6,513	605.08	Available
Unit - 4	6,513	605.08	Available
Unit - 5	6,922	643.07	Available
Unit - 6	6,922	643.07	Available
Unit - 7	7,535	700.02	Available
Unit - 8	13,143	1,221.02	Available
Unit - 9	11,969	1,111.96	Available
Unit - 10	11,969	1,111.96	Available
Unit - 11	13,293	1,234.96	Available
Unit - 12	17,728	1,646.99	Available
Unit - 13	13,293	1,234.96	Available
Unit - 14	14,628	1,358.99	Available
Total	172,547	16,030.14	

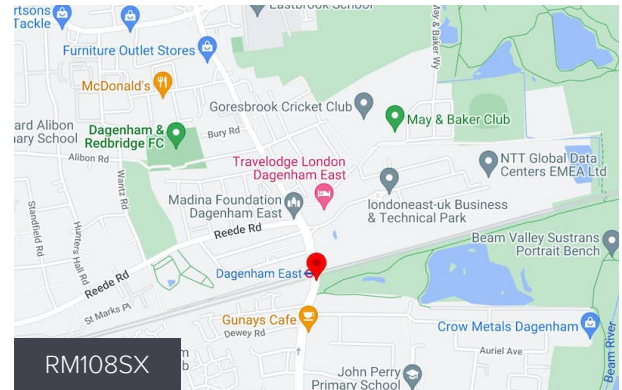
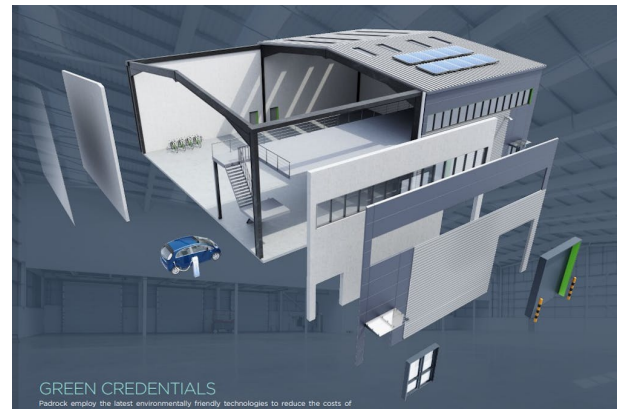

Viewing & Further Information

Sophie Cordery

07825380457 | 07825380457
sophie.cordery@m1agency.co.uk

Jonjo Lyles

020 3824 9417 | 07388 488252
jonjo.lyles@m1agency.co.uk

Freddy Macnaughton

07801736496 | 07801736496
freddy.macnaughton@m1agency.co.uk