

# Floor Plans

Unit 18 - 1053 sq ft | **Anniesland Business Park**

 Netherton Road, Glasgow, G13 1BJ

**Unit 18, Anniesland Business Park, Glasgow**  
Approximate Gross Internal Area  
1050 Sq Ft/98 Sq M

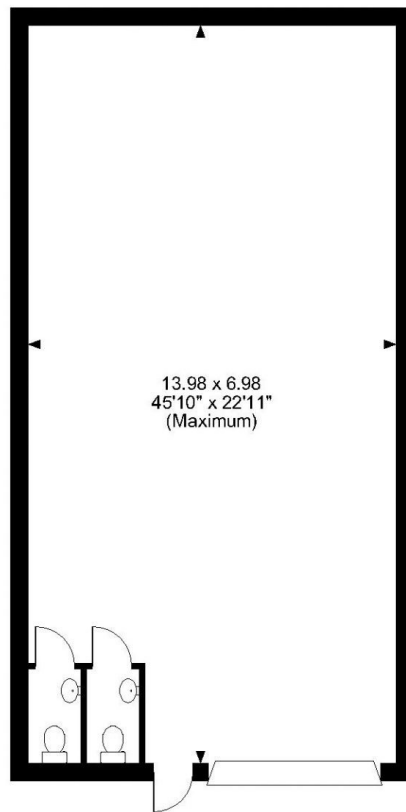
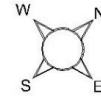

**FOR ILLUSTRATIVE PURPOSES ONLY - NOT TO SCALE**

The position & size of doors, windows, appliances and other features are approximate only.

© ehouse. Unauthorised reproduction prohibited. Drawing ref. dig/8582903/MJA