



UNIT: T5

Vita Living North

Available Now

circlesquaremanchester.com



Vita Living North

Unit T5

Circle Square Oxford Road, Manchester, M1 7ED
Permitted use : A1, A3, A4, A5

SCHEDULE OF ACCOMMODATION

The premises are arranged over ground floor only providing the following approximate net internal floor areas:

TOTAL SIZE

 **413 sq ft**
Ground floor

TERMS

The premises are available by way of a new effectively full repairing and insuring lease, for a term to be agreed.

RENT

£20,000 per annum exclusive of VAT. A service charge is payable on these premises.

Further information is available upon request.

RETAIL UNIT T5

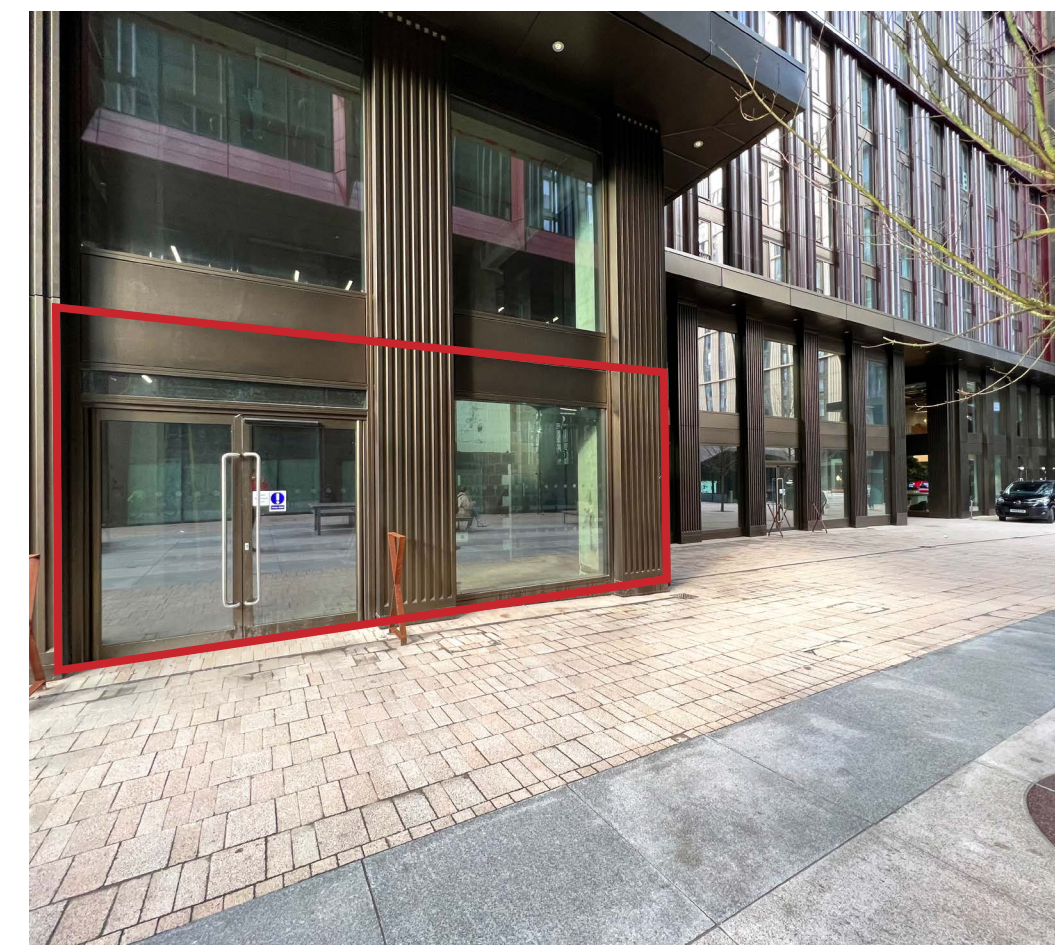

EAT. DRINK. SHOP.

Internal layout plan



GROUND FLOOR

413 sq ft

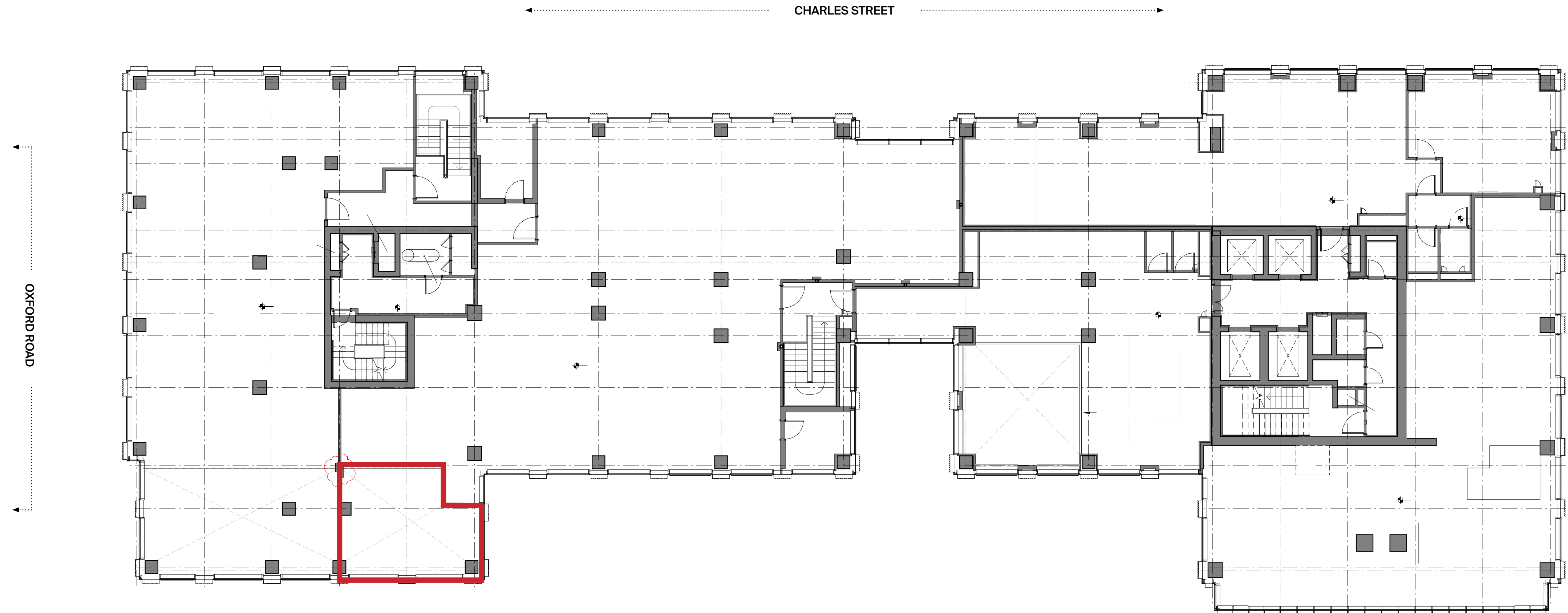

Masterplan: Retail

KEY

● Completed ● In Legals / Under Offer ● Available

01 **CANVAS**

02 **TAHI**
EXTERY

03 **LAP**
BICYCLE WORKSHOP

04 Available

05 Available

06 **FEDERAL**
CAFE & BAR

07 Available

08 **TRIB3**

09 **HELLO ORIENTAL**
MARKET

10 Available

11 **N B**

12 **Uncle T**

13 **Boo.**

14 **In Legals**
STRAIGHT LINES CIRCLES

15 Available

16 Fiori by E L & N
LONDON

17 Puisin Cosmetics

18 **Mr Su's Noodles and Dumplings**

19 One Home Minimart

20 **In Legals**

21 **bird of prey**

22 **TSUJIRI**
SINCE 1860

23 **ASDA** In Legals

24 Available

25 **TESCO**





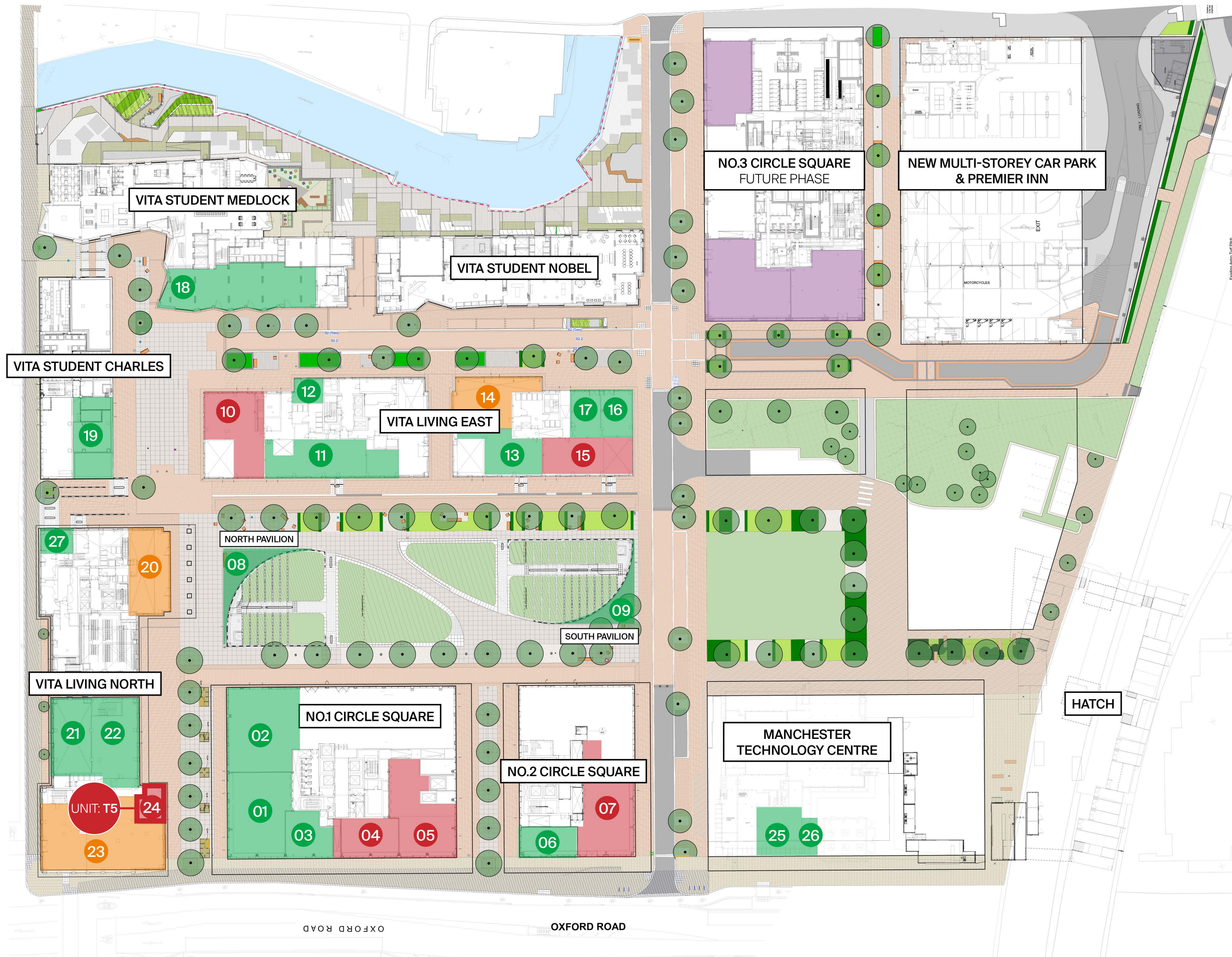



26 **little farm**
MARKET

27 Nicholls & Co Barbers



Location

Transport & Connectivity

- 
20 minutes by car
to Manchester Airport
- 
10 minutes walk
to Piccadilly Train Station
- 
Six car parks
within a 10 minute walk
- 
2 minutes walk
to Oxford Road Train Station
- 
Europe's best
connected public transport route
- 
8 minutes walk
to St Peter's Square Metrolink Interchange
- 
Direct connections
to all major rail networks
- 
 St Peter's Square provides direct routes to Victoria Station, Piccadilly Station, Manchester Airport, East Didsbury, Altrincham, MediaCityUK, Ashton-under-Lyne, Bury and Rochdale Town Centre.

Amenities

- | Restaurants / Bars | Cafes / Coffee Shops | Points of Interest | Hotels | Shops |
|-----------------------|-------------------------|-------------------------------|------------------------------------|----------------------|
| 01 Fumo | 01 Ditto Coffee | 01 Palace Theatre | 01 The Midland | 01 Tesco Express |
| 02 Gorilla | 02 Nudo Sushi Box | 02 Dog Bowl | 02 Kimpton Clocktower | 02 Sainsbury's Local |
| 03 Nando's | 03 Chango's Burrito Bar | 03 The Deaf Institute | 03 Holiday Inn Express | 03 Tesco Express |
| 04 Hatch | 04 Starbucks | 04 Manchester Aquatics Centre | 04 Hyatt Regency Hotel | 04 Co-op |
| 05 Refuge | 05 Pret a Manger | 05 Manchester Museum | 05 The Premier Inn - Circle Square | 05 Utility |
| 06 Five Guys | 06 Takk | 06 HOME | | 06 Blackwells |
| 07 Navarro Lounge | 07 R&V | 07 RNCM | | 07 One Time |
| 08 Mowgli | 08 Caffè Nero | 08 Bridgewater Hall | | |
| 09 Brew Dog | 09 The Eighth Day Cafe | 09 Manchester Art Gallery | | |
| 10 YES | | | | |
| 11 Wood | | | | |
| 12 Street on 1st | | | | |
| 13 The Gas Works | | | | |
| 14 Indian Tiffin Room | | | | |
| 15 Bundobust | | | | |



Masterplan



480,000 sq ft
commercial office space



1,100 high quality
student apartments

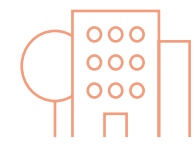

683 private rented
sector apartments



Who's here

Leading digital technology businesses



Occupiers include:

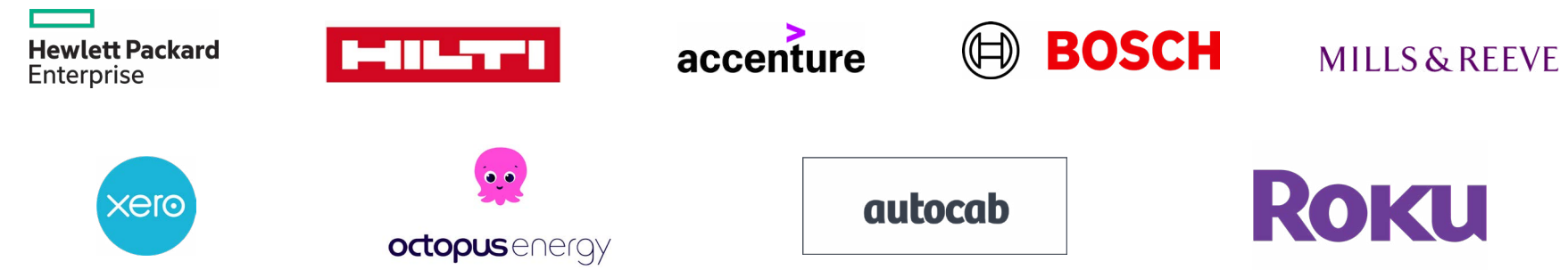

Residents

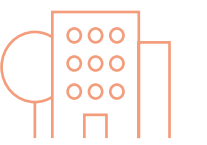

Vita Living East (266 apartments) **100% occupied**

Vita Living North (411 apartments) **100% occupied**

Students



1,100 apartments across three buildings

Current occupancy 100%

91,000



Oxford Road **average weekly footfall**



Circle Square
Oxford Road
Manchester
M1 7ED

info@circlesquaremanchester.com
circlesquaremanchester.com



Chris Middleton
Retail Asset Manager
07977 433 850
chris.middleton@vitagroup.com



Jonathan Thompson
0161 260 0062
07810 656 006
jt@ltlproperty.com



Conor Mulloy
0161 302 5312
07841 661 990
conor.mulloy@g-s.co.uk

A development by:



February 2023. Subject to Contract.

Misrepresentation Act: The agent, for themselves and for the vendors or lessors of this property for whom they act, give notice, that;
(i) these particulars are a general outline only, for the guidance of prospective purchasers or tenants, and do not constitute the whole or any part of any offer or contract; (ii) the agent cannot guarantee the accuracy of any description, dimensions, references to condition, necessary permission for use and occupation and any other details contained herein and prospective purchasers or tenants must not rely on them as statement of fact or representation and must satisfy themselves as to their accuracy; (iii) no employee of the agent has any authority to make any representation or warranty or enter into any contract in relation to the property; (iv) prices/rents quoted in these particulars may be subject to VAT; (v) the agent will not be liable, in negligence or otherwise, for any loss arising from use of these particulars. Any photographs and plans attached to these particulars were correct at the time of production and are for reference, rather than fact.

