



Old Bank House, Cleobury Road, Clows Top, Worcestershire

**G HERBERT
BANKS**

EST. 1898

**Old Bank House,
Cleobury Road, Clows Top,
KIDDERMINSTER DY14 9HL**

Commercial (Class E) Premises with three bedroom residential accommodation

- Located centrally to Clows Top Village
- Three Bedroom Semi-Detached Generous Living Accommodation
- Suitable for a variety of business uses (subject to planning)

Distances in Miles

Bewdley 5 ½ * Kidderminster 9 * Worcester 16

Situation

Old Bank House is located in the village of Clows Top overlooking the B4202 Cleobury Road. Rear access off the main road leads into a pleasant shared courtyard surrounded by other period properties.

Clows Top is provided with good road access to Kidderminster, Tenbury Wells, Cleobury Mortimer and with Worcester further to the south and Ludlow to the west.

Description

Old Bank House is a character period property which has been sympathetically extended to the rear and side, providing attractive family accommodation. Historically having been the former bank this property is now largely residential, but inset with an established Butchers premises.

The retail unit has direct access from the street and being Class E, this premises would be suitable for a range of uses including professional services, beauty or retail. The shop leads into the residential accommodation with a long fitted galley kitchen, two

reception rooms, the sitting room with a Calor gas 'Log burner' style stove and an open fireplace in the dining room and doors out to the two outside seating areas which have been attractively landscaped.

To the first floor there are three bedrooms and a further room, which maybe incorporated into a master bedroom suite, used as a nursery or study. There is a fitted family bathroom.

To the outside of the property there is a brick built garage. There is a wooden summer house with power and further storage cupboard.

GENERAL INFORMATION

Services

The property is connected to mains electricity and water. Drainage is provided to a septic tank.

Local Authority

Malvern Hills District Council Tel: 01684 862 221

Business Rates

Malvern Hills District Council Tel: 0300 456 0560
Email: malvernbrates@southworcestershire.revenues.gov.uk

Fixtures and Fittings

Any items of this nature not specifically mentioned within the confines of these sales particulars maybe available by separate negotiation. Otherwise, any items of this nature not specifically mentioned within the confines of these sales particulars are to be excluded from the sale.

Viewing

Via the Sole Agent's Great Witley Office

Business Rates

Tel: 01299 896968.

Contact: Nick Jethwa nj@gherbertbanks.co.uk

Joshua Philips jp@gherbertbanks.co.uk

Energy Performance Certificate

EPC Rating F24

Directions

From Great Witley follow the A443 up the hill and take first left onto the B4202 through Abberley signposted Cleobury Mortimer. At the cross roads in Clows Top, proceed straight over and Old Bank House/Brian's Butchers is the red brick property immediately on your left hand side.



Old Bank House, Clows Top, Kidderminster, DY14

Approximate Area = 1283 sq ft / 119.2 sq m

Limited Use Area(s) = 99 sq ft / 9.2 sq m

Total = 1382 sq ft / 128.3 sq m

For identification only - Not to scale

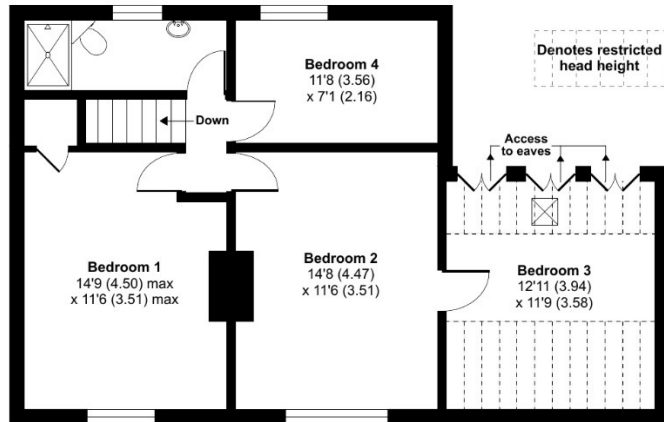

FIRST FLOOR

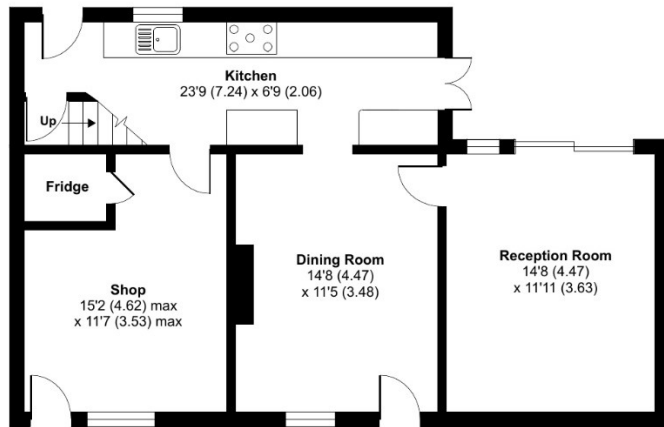

GROUND FLOOR



Floor plan produced in accordance with RICS Property Measurement Standards incorporating International Property Measurement Standards (IPMS2 Residential). © nichecom 2023. Produced for G Herbert Banks LLP. REF: 1015989



G HERBERT BANKS

EST. 1898

01299 896 968
info@gherbertbanks.co.uk
www.gherbertbanks.co.uk

The Estate Office, Hill House
 Great Witley, Worcestershire WR6 6JB



AGENTS NOTE The Agents would stress that these particulars have been written as a guide to the prospective purchaser and that measurements are approximate. If a prospective purchaser requires clarification on any point mentioned within these particulars they are asked to contact the Agents. The property is sold with all faults and defects, whether of condition or otherwise and neither the Vendor nor the Agents of the Vendor, are responsible for any such faults or defects or for any statements contained in the general remarks, summaries or particulars of sale of the property prepared by the said Agents. The purchaser shall be deemed to acknowledge that he has not entered into this contract in reliance of any of the said statements, that he has satisfied himself as to the correctness of each of the statements by inspection or otherwise and that no warranty or representation has been made by the Vendor or the said Agents in relation to, or in conjunction with, the property. The plan and quantities are based on the last Ordnance Survey sheets as revised by the Agents. Where fields or enclosures have been divided, the areas have been estimated by the Agents and the quantities are believed to be correct and shall be so accepted by the purchasers. G Herbert Banks LLP is a limited liability partnership registered in England and Wales with registered No. OC344076. G Herbert Banks LLP is a member of The Property Ombudsman.

