

## Land at Mostyn Road, Wimbledon SW19 3LS



**For Sale Freehold**

**Guide Price £100,000**

Vacant plot of land extending to approximately 1,453 sq ft./135 sq m (areas provided by vendor).  
The land is located behind 153 Mostyn Road with various access points and currently there is a garage on it.  
On adjoining land, a new single storey dwelling is being constructed (LB Merton Planning Consent 19/P1235).  
We understand this to be a one bedroom detached property with a GIA of approximately 590 sq. ft.  
This precedent may assist a buyer to obtain planning permission.

**Contacts: Robin Catlin or Stewart Rolfe**

**020 8971 4999**

**24 High Street, Wimbledon Village, SW19 5DX**

**Email: [commercial@as-r.co.uk](mailto:commercial@as-r.co.uk)**

- Plot of land with potential for residential development (subject to all consents)
- Close to Mostyn Gardens
- Approx site area 1,453 sq ft / 135 sq m
- Historic covenants in title
- Tramlink at Merton Park (1.0 mile)
- Short walk to Morden (0.5 mile)
- Thameslink at South Merton Station (0.1mile)
- South Wimbledon - Northern Line (1.2miles)
- Wimbledon Town Centre/ Station (1.4miles)





# Mostyn Road

Approximate Gross Internal Area = 1453 sq ft / 135 sq m

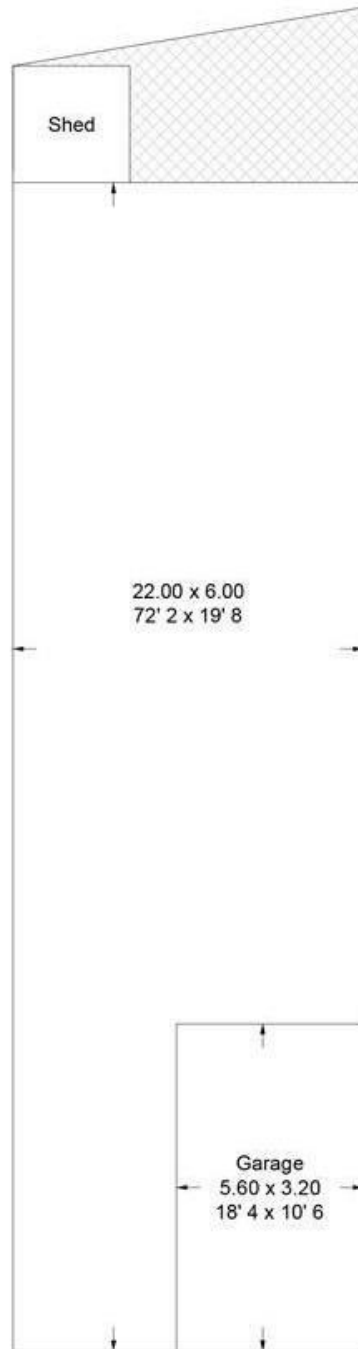

This plan is not to scale and must be used as layout guidance only. All measurements and areas are approximate and should not be relied upon to provide accurate information. This plan must not be relied upon when making property valuations, design considerations or any other such relevant decisions. We accept no responsibility or liability (whether in contract, tort or otherwise) in relation to any loss whatsoever arising from or in connection with any use of this plan or the adequacy, accuracy or completeness of it or any information within it.



Note: andrew scott robertson for itself and for the vendors or lessors of this property whose agents they are give notice that:

- (i) the particulars are set out as a general outline only for the guidance of intending purchasers or lessees, and do not constitute, nor constitute part of, an offer or contract
- (ii) all descriptions, dimensions, references to condition and necessary permissions for use and occupation, and other details are given in good faith and are believed to be correct but any intending purchasers or tenants should not rely on them as statements or representations of fact but must satisfy themselves by inspection or otherwise as to the correctness of each of them;
- (iii) no person in the employment of andrew scott robertson has any authority to make or give any representation or warranty whatsoever in relation to this property. February 2024