

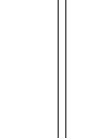
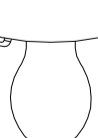
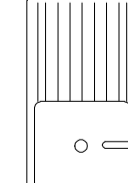
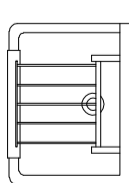
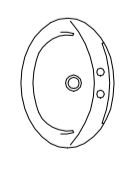

**DRAWING NOTES**

This drawing (and associated documentation) is the copyright of UKBS LTD. The drawing (or any part thereof) may not be copied, transmitted or disclosed to any third party without the prior written consent of the UK Building Surveys.

Under no circumstances should dimensions be scaled from this drawing. All dimensions and/or levels are to be checked on-site prior to the commencement of any work. Any discrepancies to be reported to the UKBS Offices or representative thereof immediately. 'IF IN DOUBT ASK.'

**LEGEND**

-  - Windows
-  - Toilet
-  - Kitchen Sink
-  - Sluice
-  - Hand Basin
-  - Ceiling Height

| Rev               | Description | Drawn | Date | CHK'd | App'd |
|-------------------|-------------|-------|------|-------|-------|
|                   |             |       |      |       |       |
| <b>AMENDMENTS</b> |             |       |      |       |       |
|                   |             |       |      |       |       |

**UK Building Surveys**  
 15 Broughton Chase  
 Grappenhall Heys  
 Warrington  
 Cheshire WA4 3DR  
 Mobile 07751 533 627  
 Email: [enquiries@ukbuilding.co.uk](mailto:enquiries@ukbuilding.co.uk)

|                       |  |
|-----------------------|--|
| <b>Site</b>           |  |
| Building 1            |  |
| Croxley Business Park |  |
| Hatters Lane          |  |
| Watford               |  |
| WD18 8YR              |  |
| <b>Title</b>          |  |
| Building 1            |  |
| Croxley Business Park |  |
| Hatters Lane          |  |
| Watford               |  |
| WD18 8YR              |  |

|             |           |  |           |        |            |
|-------------|-----------|--|-----------|--------|------------|
| Surveyed By | MAS       | Checked By                                     | HJH       | Status | Original   |
| Designed By |           | Approved By                                    | MAS       |        |            |
| Scale       | 1:100     | CAD File                                       | USSS-9039 | Date   | 03/01/2022 |
| Sheet Size  | A0        | Existing Ground Floor Plan - IPMS3 Measurement |           |        |            |
| Drawing No  | UKBS-9039 |  |           |        | Rev        |

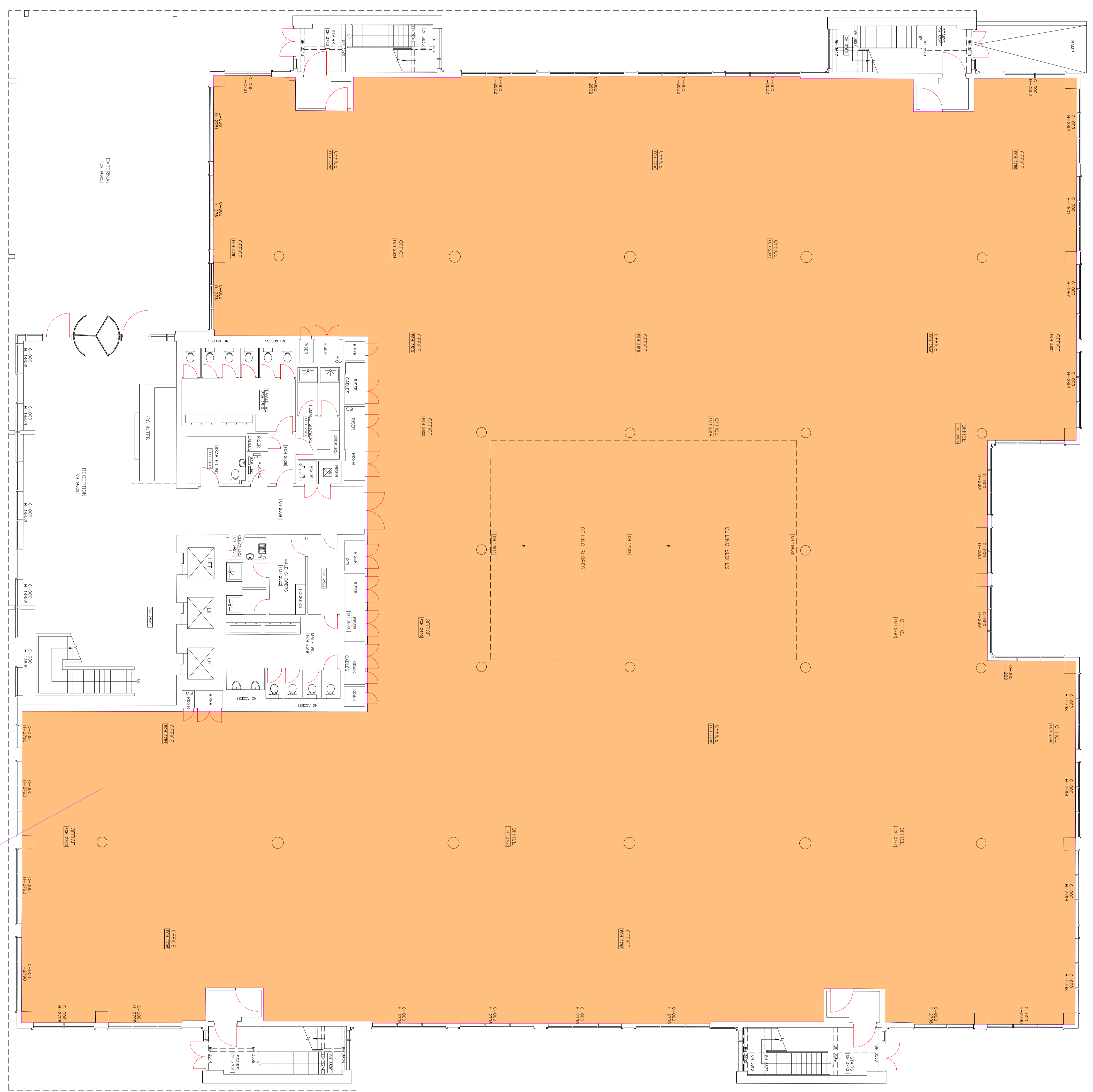

**GROUND FLOOR**  
 0 2 10 METERS

IPMS3 MEASUREMENT  
 2069.61 SQM