

BASEMENT

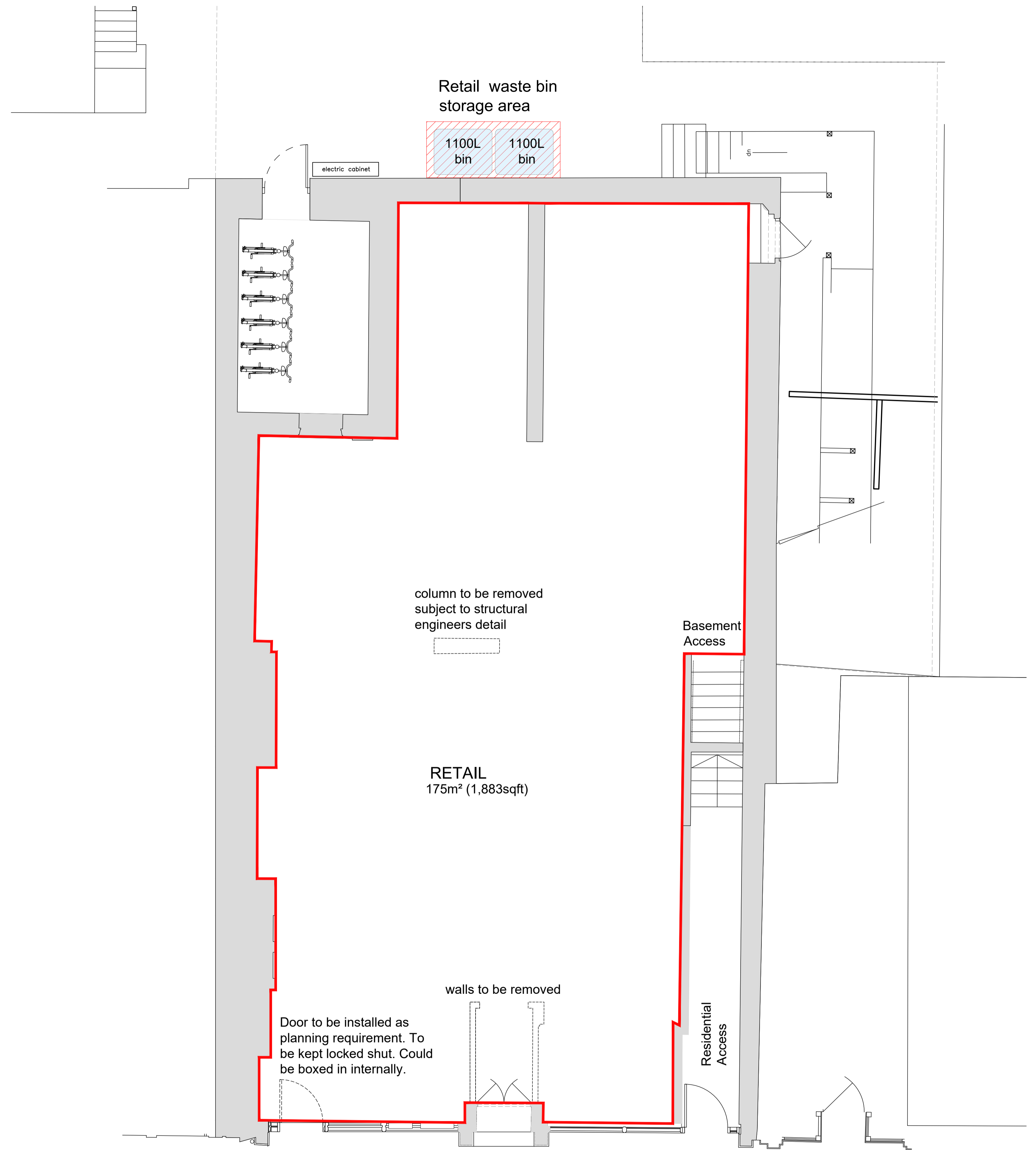

GROUND FLOOR

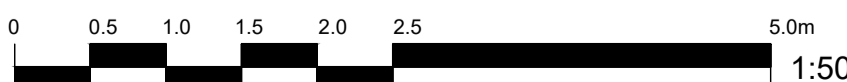
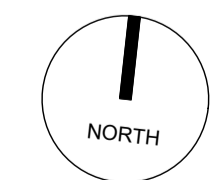

The copyright of this drawing is vested with Corstorphine & Wright Ltd and must not be copied or reproduced without the consent of the company.

Rev.	Description	Date	Drawn	Chk.
04	residential corridor extended to GF	14.02.23	PA	IP
03	cycle parking added to GF	25.11.22	PA	IP
02	Bins storage added	24.11.22	PA	IP
01	Cycle parking added to basement	22.11.22	PA	IP

Client  
Golden Key Estates  
Project  
91 Regent Street,  
Leamington Spa, CV32 4NT  
Drawing Title  
Lease Plan, Ground  
and Basement Levels  
Drawing Status  
INFORMATION

**Corstorphine & Wright**

Warwick Studio  
Brook Hall, Brook Street, Warwick, CV34 4BL  
01926 652 444  
corstorphine-wright.com

Drawing No. 22196-150	Revision 04
Drawn pa	Checked ip
Paper Size A1	Scale 1:50
Date June 2023	