

The copyright of this drawing is vested with Corstorphine & Wright. Any reproduction shall not be copied or reproduced without the consent of the Company.  
 Figures dimensions only to be taken from this drawing. DO NOT SCALE. Manufacturer's must read the site and be responsible for checking all settings and dimensions and notifying the architect of any discrepancies prior to any manufacture or construction work.  
 NOTES

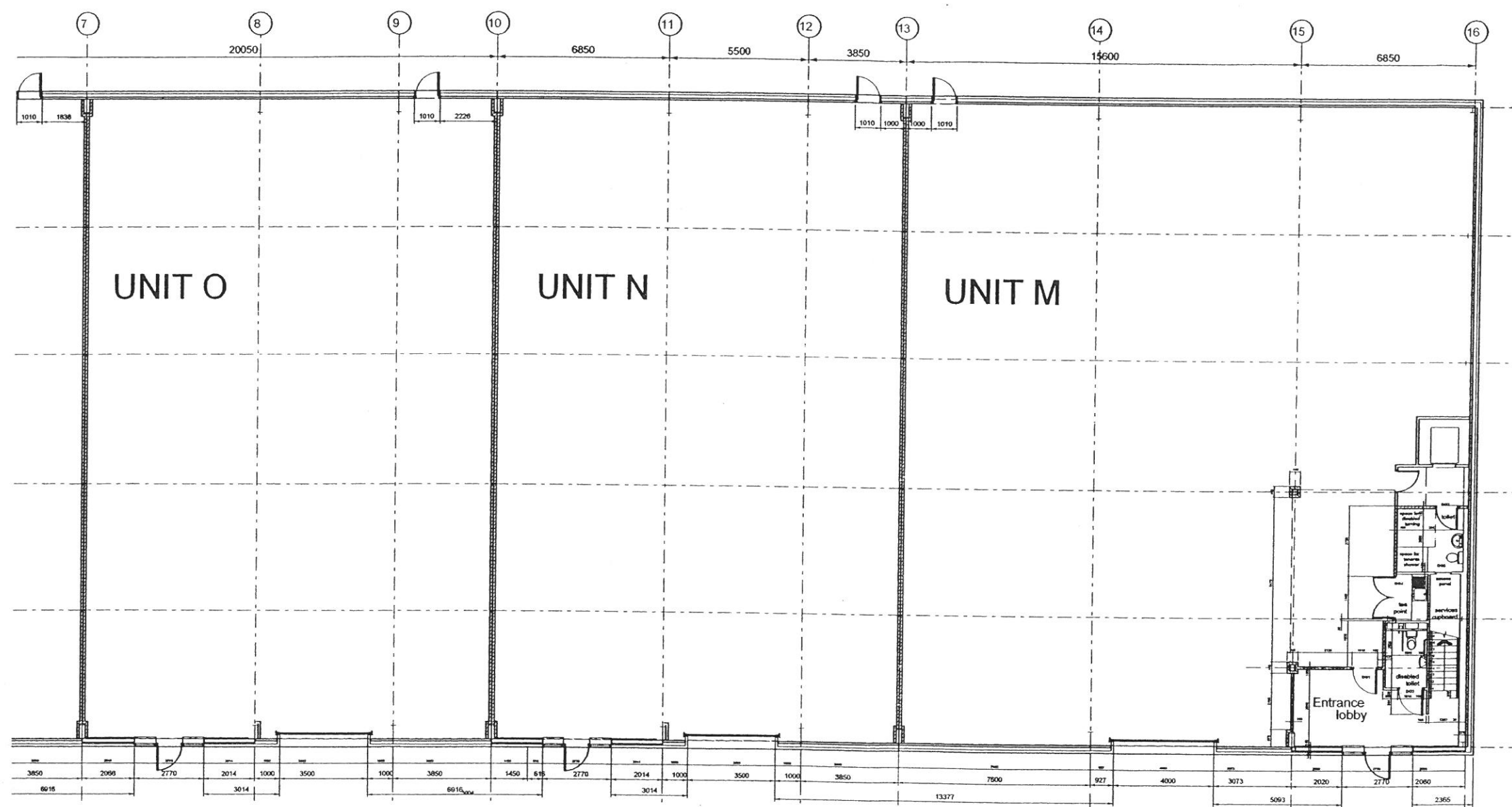

UNITS O, N & M of M-Q

Rev.	Date	By	Description
Client			

**The io Group Limited**

**CORSTORPHINE & WRIGHT**

CORSTORPHINE & WRIGHT - KENZIE LOVELL LIMITED  
 BRICK HALL, BRICKS, STAMFORD, WARWICK CV34 4BL  
 TEL: 01926 402323 FAX: 01926 415318

Project  
 io centre  
 HATFIELD BUSINESS PARK

Drawing Title  
 PLANS - UNITS M-Q. sheet 2  
 GROUND FLOOR - OPTION 2

Drawn PM	Check DP	Scale 1:100	Date 26.03.04
Proj. No. 01170	Drawing No. 1255	Rev.	



The copyright of this drawing is vested with Corstorphine & Wright. Kenzie Lovell Limited and must not be copied or reproduced without the consent of the Company.  
 Figured dimensions only to be taken from this drawing. DO NOT SCALE. Manufacturers must visit the site and be responsible for checking all settings and dimensions and notifying the architect of any discrepancies prior to any manufacture or construction works.  
 NOTES

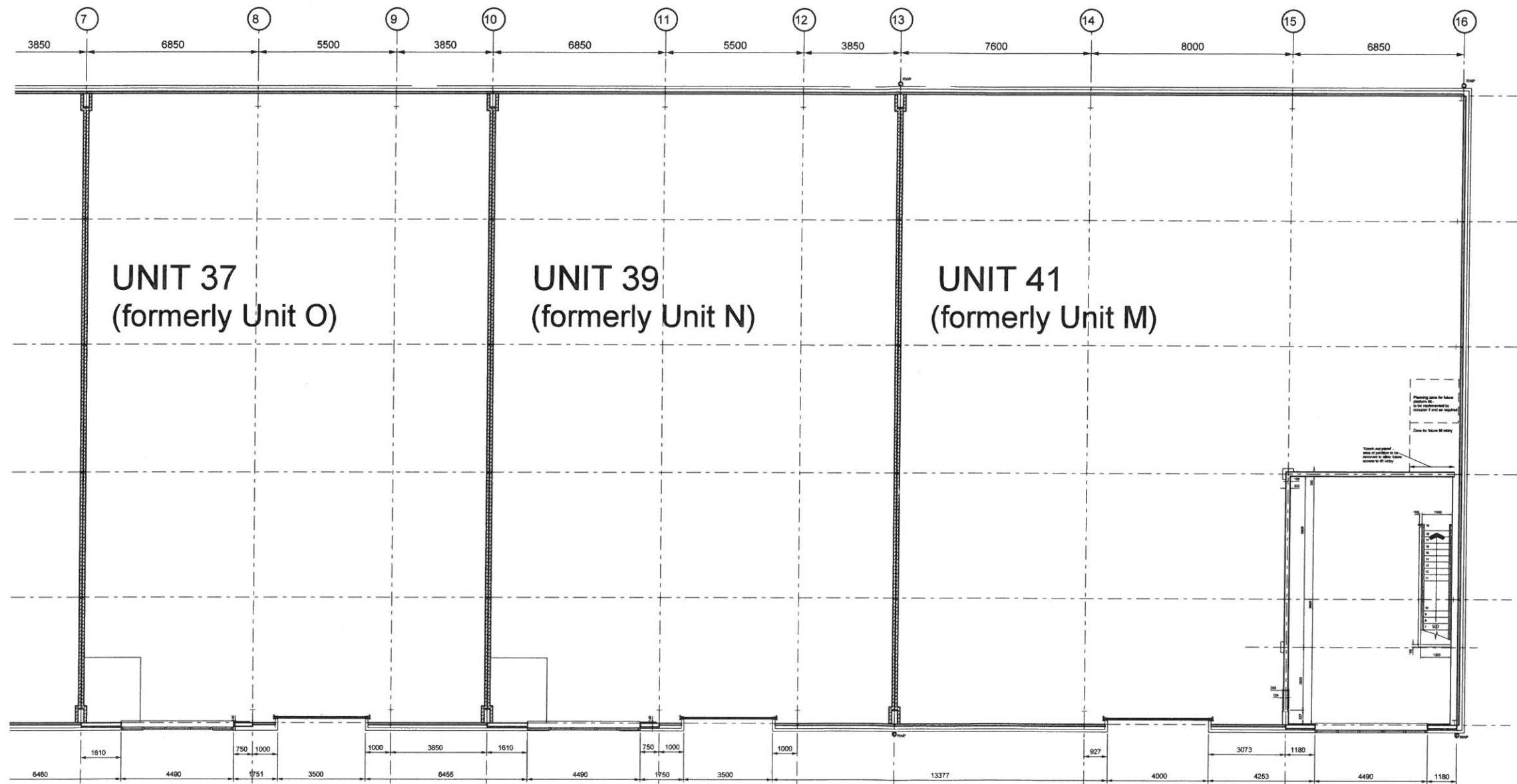

UNITS 37, 39 & 41 of 33-41

**AS BUILT**

Rev. D	13.12.04	TA	AS BUILT
Rev. C	18.08.04	TA	Drainage points, incoming services, sep locations shown
Rev. B	10.05.04	TA	'rds' to ground floor toilet added units N, O and P.
Rev. A	28.04.04	TA	Corse to units N, O and P omitted.
Rev.	Date	By	Description

Client

The *io* Group Limited

**CORSTORPHINE & WRIGHT**

CORSTORPHINE & WRIGHT • KENZIE LOVELL LIMITED

Brook Hill, Brook Street, Warwick CV34 4BL  
 Tel: 01926 402323 Fax: 01926 495318

Project

*io* centre

HATFIELD BUSINESS PARK

Drawing Title

PLANS - UNITS 37, 39 and 41  
 FIRST FLOOR

Drawn	PM	Checked	OP	Scale	1:100	Date	28.03.04
Job No.	01170	Drawing No.	1257	Rev.			D

KENZIE LOVELL

11