



REDHEUGH
A7 | GOREBRIDGE

COMMERCIAL / EMPLOYMENT DEVELOPMENT OPPORTUNITY

APPROX 10.38 HA (22.5 ACRES)
PLOTS AVAILABLE FROM 1 ACRE UPWARD
PLANNING GRANTED FOR CLASS 4 & 5
POTENTIAL RETAIL STP

LOCATION

The site is located on the West side of the A7, which is the main arterial route between Edinburgh and Galashiels. The site is approximately 13 miles South of Edinburgh City Centre and 21 miles North of Galashiels. The site benefits from close proximity to the Borders Railway line with Newtongrange and Gorebridge stations in the vicinity. The Redheugh residential expansion of approx 700 units sits to the west of the site.

- 01 BONNYRIGG
- 02 EDINBURGH
- 03 CITY OF EDINBURGH BYPASS (720)
- 04 ESKBANK / DALKEITH
- 05 NEWTONGRANGE RAILWAY STATION
- 06 NEWTONGRANGE
- 07 BUTTERFIELD INDUSTRIAL ESTATE
- 08 REDHEUGH RESIDENTIAL DEVELOPMENT
- 09 GOREBRIDGE



PLANNING

The site has the benefit of a resolution to grant Planning Permission in Principle (22/00588/s42) made on 10th January 2023 for Class 4 (Business – office, R&D and light manufacturing) and Class 5 (General Industrial) to be granted for 5 years once an updated s75 is registered. Details of the s75 can be provided upon request.

Figure 4.4 “Retail Centres” identifies an area covering the site as a “Potential Site of New Supermarket” and policy TCR2 in the adopted 2017 Midlothian LDP allows for convenience retail in this area subject to securing planning consent.

THE SITE

The land comprises a roughly rectangular shaped site of approx. 9.1 ha (22.5 acres) with a lower level area in the north west (tree area) and upper level the remainder. The site directly fronts the A7 and 2 access points are to be formed from the A7. Development plots are available to purchase on a long leasehold basis. Design & Build opportunities may be considered.

Outlined below is an indicative masterplan layout which highlight the 2 proposed access points from the A7.

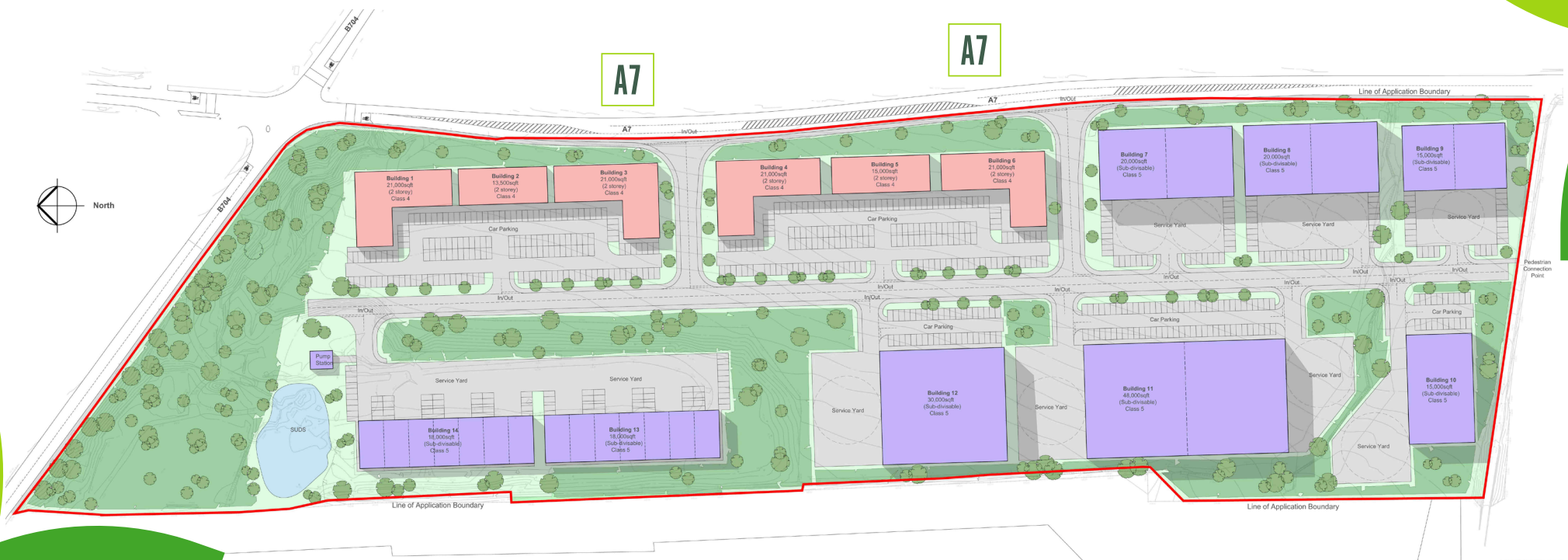



CONTACT & FURTHER INFORMATION

For further information please contact the joint letting agents.

Ryden.co.uk
0131 225 6612

David Fraser
david.fraser@ryden.co.uk
07827 33138

Cameron Whyte
cameron.whyte@ryden.co.uk
07789 003148

Alan Herriot
alan.herriot@ryden.co.uk
07880 722326



Ross Sinclair
rsinclair@savills.com
07557 972955

Ben Brough
bbrough@savills.com
07968 553308



The agents for themselves and for vendors or lessors of this property whose agents they are give notice that: (i) the particulars are set out as a general outline only for the guidance of intended purchasers or lessees, and do not constitute, nor constitute part of, an offer or contract; (ii) all descriptions, dimensions, reference to condition and necessary permissions for use and occupation, and other details are given without responsibility and any intending purchasers or tenants should not rely on them as statements or representations of fact but must satisfy themselves by inspection or otherwise as to the correctness of each of them; (iii) no person in the employment of the agents has any authority to make or give any representation or warranty whatever in relation to this property. **May 2023.** Designed by www.thefifthhouse.co.uk