



TO LET

Units 5 – 6

FORTIES INDUSTRIAL CENTRE



Hareness Circle
Altens Industrial Estate
Aberdeen AB12 3LY

890.10 SQ M (9,581 SQ FT)





TO LET

Units 5 - 6

FORTIES INDUSTRIAL CENTRE

▣ LOCATION

The subjects are located within Altens Industrial Estate, the premier south-side industrial location, approximately 2 miles south of the city centre. The estate benefits from direct access to Wellington Road (A956) which connects to the A90 trunk road.

Altens is also in close proximity to Aberdeen Harbour and Hareness Road forms the main access route to the new South Harbour. The estate also forms part of the newly formed Energy Transition Zone – a location for the accelerated development of a net zero energy cluster to attract new investment and deliver net zero.

The subject property is located on Hareness Circle close to its junction with Hareness Road.

Surrounding occupiers include Taylors Industrial Waste, Baker Hughes, Wood, Weatherford and Tuffhells.



▣ DESCRIPTION

Forties Industrial Centre comprises a multi-let industrial scheme comprising of 9 individual units over two terraces of warehouse accommodation.

The subjects comprise an end-terraced of 2 inter-connected units. Internally, the subjects comprise of workshop space together with ancillary office accommodation and staff facilities.

The subjects benefit from the following specification:

- Steel portal frame construction with concrete floors
- Insulated pressed steel cladding
- 6 metre eaves height
- High bay LED lighting
- Vehicle access via a number of electric roller shutter doors
- 3 phase power supply
- Secure mono block yard area

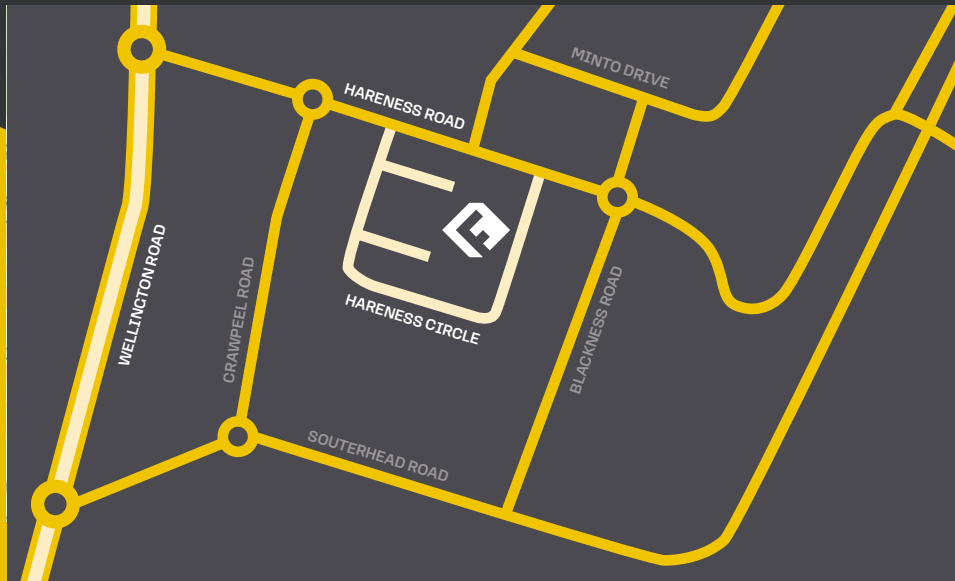



**Units
5 - 6**





TO LET

Units 5 - 6

FORTIES INDUSTRIAL CENTRE

▫ **ACCOMMODATION**

The premises extend to the following approximate gross internal floor areas: The units benefit from a secure yard area to the front which extends to approximately 642.88 sq m (6,920 sq ft).

Unit 5	Sq M	Sq Ft
Office	70.75	762
Warehouse	373.40	4,019
SUB TOTAL	444.15	4,781

Unit 6	Sq M	Sq Ft
Warehouse	445.95	4,800
TOTAL	890.10	9,581

The units benefit from a secure yard area to the front which extends to approximately 980 sq m (10,556 sq ft).

▫ **RENTAL**

£80,000 per annum.

All rents quoted are exclusive of VAT and payable quarterly in advance.

▫ **SERVICE CHARGE**

The tenant will be responsible for the payment of a service charge in relation to the maintenance, upkeep and repair of the common areas of the estate.

Further details are available on request.

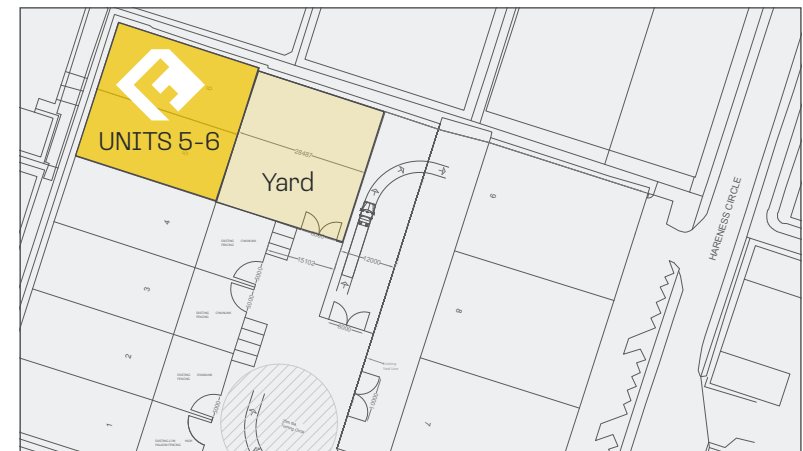
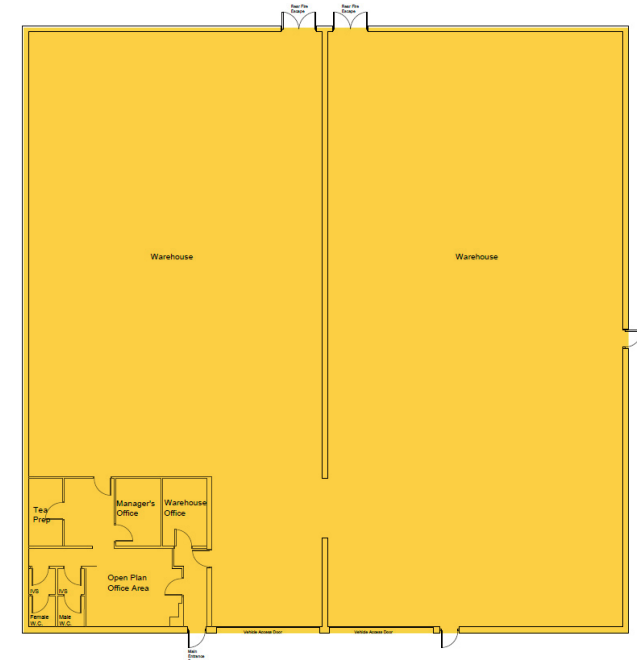



Units 5 – 6

FORTIES

INDUSTRIAL CENTRE





▫ **RATEABLE VALUE**

£53,000, effective from 1 April 2023.

▫ **ENERGY PERFORMANCE CERTIFICATE**

Further information is available upon request.

▫ **VIEWINGS & OFFERS**

For further information or viewing please contact the joint agents.

Iain Landsman
Director
07880 480 298
iain.landsman@hm-re.co.uk



Paul Richardson
Partner
01224 588 866
paul.richardson@ryden.co.uk



Important Notice. Hutcheon Mearns Real Estate Limited and Ryden, their clients and any joint agents give notice that:

1. They are not authorised to make or give any representations or warranties in relation to the property either here or elsewhere, either on their own behalf or on behalf of their client or otherwise. They assume no responsibility for any statement that may be made in these particulars. These particulars do not form part of any offer or contract and must not be relied upon as statements or representations of fact.
2. Any areas, measurements or distances are approximate. The text, photographs and plans are for guidance only and are not necessarily comprehensive. It should not be assumed that the property has all necessary planning, building regulation or other consents and Hutcheon Mearns Real Estate Limited and Ryden have not tested any services, equipment or facilities. Purchasers must satisfy themselves by inspection or otherwise. May 2023

