

notes
Do not scale from this drawing. All dimensions are to be checked on site. Any discrepancies must be reported to the Designer immediately.

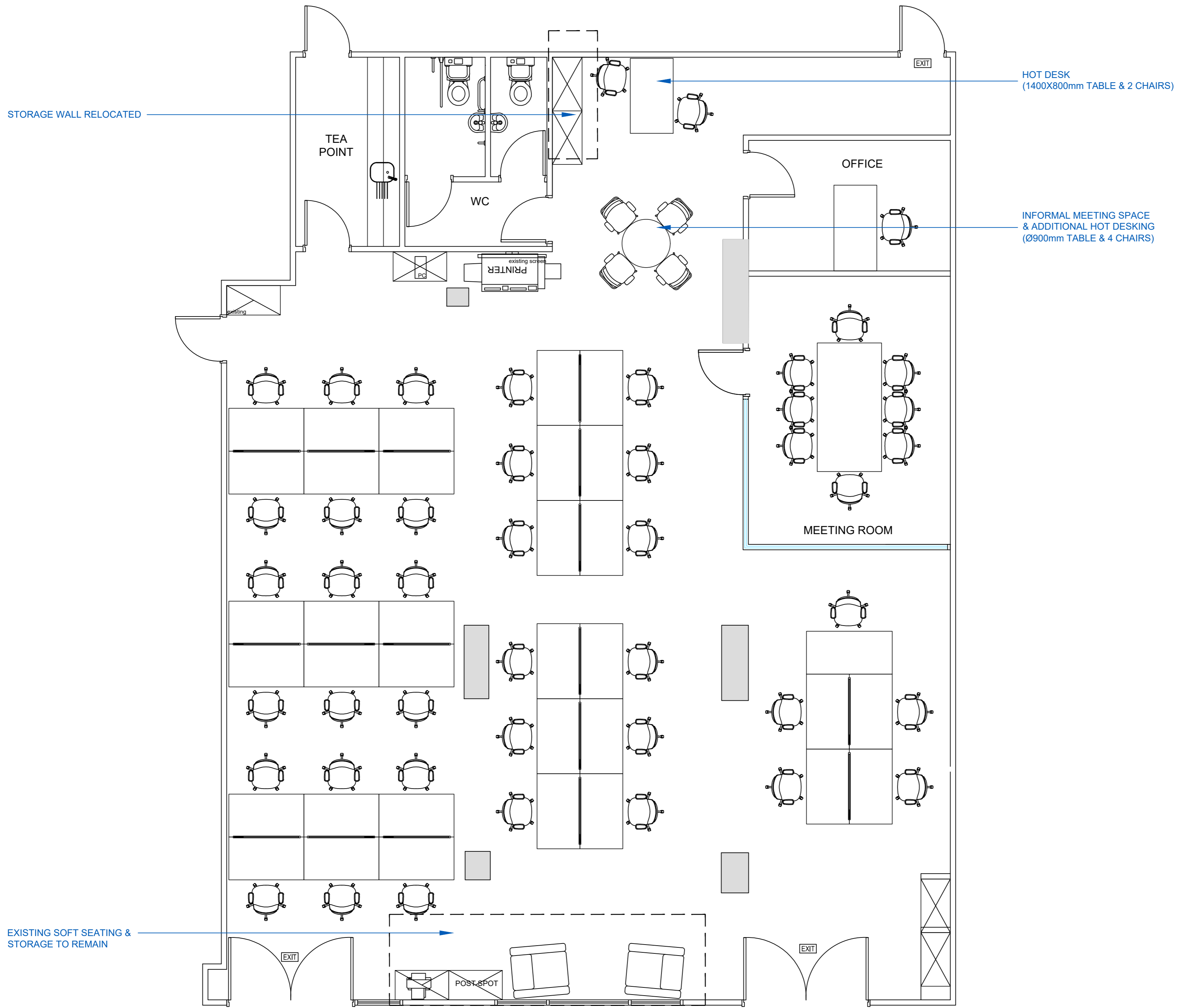

OCCUPANCY:

- 30 WORKSTATIONS
- 1 PRIVATE OFFICES
- 1 MEETING ROOM
- 1 VIEWING ROOM

| rev | date | note | by | checked |
|-----|----------|--|----|---------|
| F | 07.11.17 | GLASS PARTITION RELOCATED | AC | SG |
| E | 01.10.17 | FEASIBILITY FOR 35 SEATS | AC | SG |
| D | 13.04.15 | SOFT SEATING & HOT DESKS REVISED, ADD GLASS WALL | DW | SG |
| C | 02.04.15 | REMOVE NEW WC, ROTATE DESKS | RS | SG |
| B | 30.05.14 | REMOVE PRINTER, ADD WHITE BOARD & EX WALL SCRIN | RS | SG |
| A | 04.04.14 | ADD 1 DESK, REDUCE STORAGE UNITS | RS | SG |



Orchard House, Threshelfords Business Park, Inworth Road, Feering, Essex, CO5 9E
 T: 020 7061 9866 | F: 020 7061 9877
 E: info@orchardgroup.org.uk | W: www.orchardgroup.org.uk

client
BRANDING SCIENCE

project
**9b COMPASS HOUSE
SMUGGLERS WAY
LONDON SW18 1DB**

drawing
**GROUND FLOOR
PROPOSED LAYOUT
option 2**

| status | drawing no. | | | | |
|-------------|-------------|----------|----------|-------|---------|
| PRELIMINARY | OB405 | | | | |
| date | job no. | revision | scale | drawn | checked |
| APRIL'14 | OB405 | E | 1:50(A2) | AC | SG |

Orchard Group ©
 Copyright of this drawing is held by Orchard. It is issued on the condition that it is not copied, reproduced or disclosed to any third party without written consent from Orchard.