

- KEY**
-  NEW PROPOSED TREES
  -  NEW GRASSED AREA
  -  EXISTING TREE
  -  EXISTING HEDGE

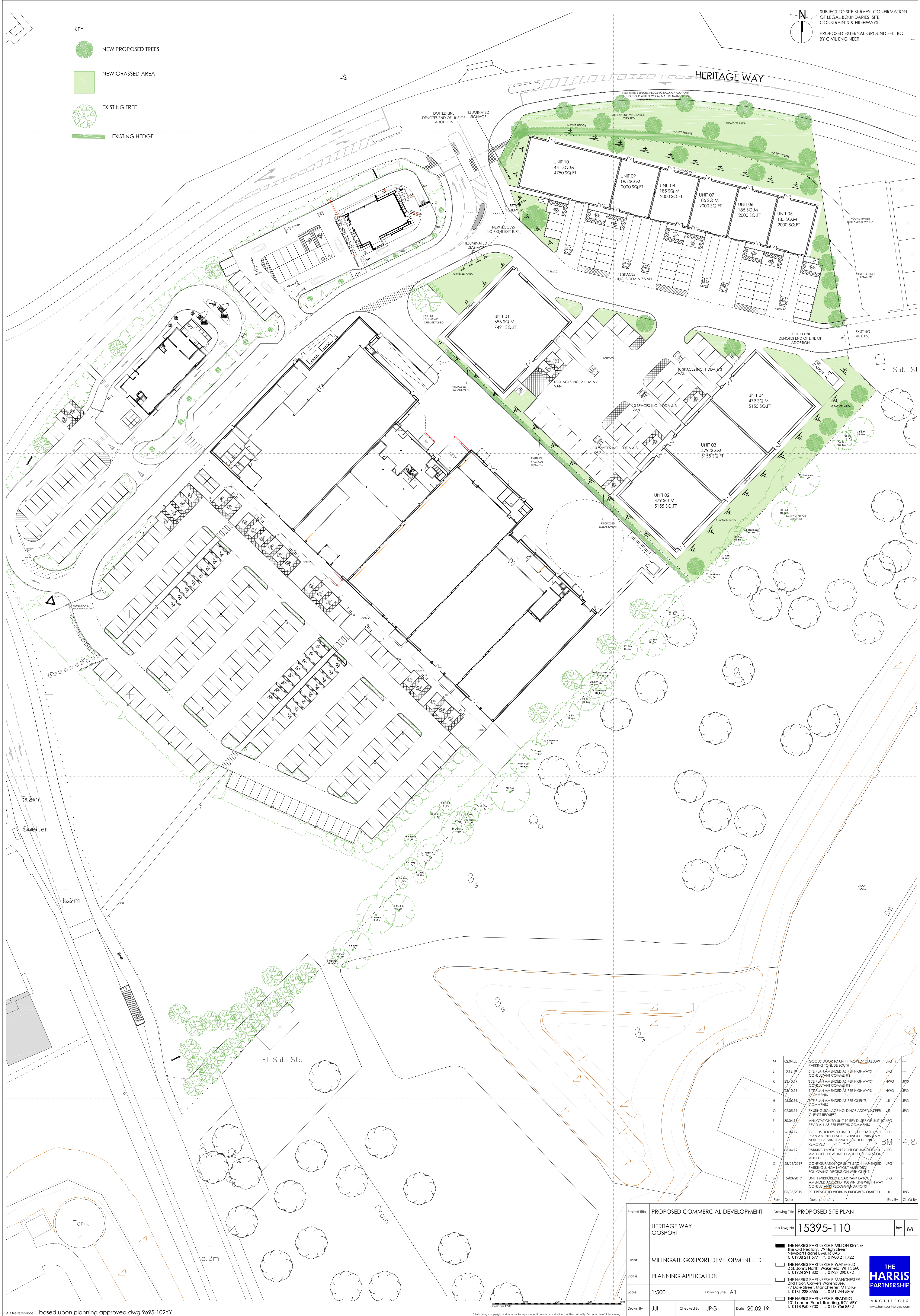

Rev	Date	Description	Rev By	CHKD BY
M	02.04.20	GOODS DOOR TO UNIT 1 MOVED TO ALLOW PARKING TO SLIDE SOUTH	JPG	
L	10.12.18	SITE PLAN AMENDED AS PER HIGHWAYS CONSULTANT COMMENTS	JPG	
K	23.03.19	SITE PLAN AMENDED AS PER HIGHWAYS CONSULTANT COMMENTS	HWG	JPG
J	23.10.19	SITE PLAN AMENDED AS PER HIGHWAYS CONSULTANT COMMENTS	HWG	JPG
H	25.02.19	SITE PLAN AMENDED AS PER CLIENTS COMMENTS	JJI	JPG
G	02.05.19	LOADING SIGNAGE HOLDINGS ADDED AS PER CLIENTS REQUEST	JJI	JPG
F	30.04.19	ANNOTATION TO UNIT 10 REV'D. SIZE OF UNIT 10 REV'D AS PER TREE'S COMMENTS	JJI	JPG
E	24.04.19	GOODS DOORS TO UNIT 1 TO UPDATED SITE PLAN AMENDED ACCORDINGLY. UNITS 8 & 9 NEXT TO REAR TERRACE GRANTED. UNIT 10 REMOVED	JJI	JPG
D	26.04.19	PARKING LAYOUT IN FRONT OF UNITS 5 TO 10 AMENDED. NEW UNIT 11 ADDED. SUB STATION ADDED	JJI	JPG
C	28/03/2019	CONFIGURATION OF UNITS 5 TO 11 AMENDED. PARKING & CAR PARK LAYOUT AMENDED FOLLOWING DISCUSSION WITH CLIENT	JJI	JPG
B	15/03/2019	UNIT 1 MIRROREY & CAR PARK LAYOUT AMENDED ACCORDING TO LINE WITH HWY CONSULTANTS RECOMMENDATIONS	JJI	JPG
A	05/03/2019	REFERENCE TO WORK IN PROGRESS OMITTED	JJI	JPG

Project Title		PROPOSED COMMERCIAL DEVELOPMENT	
Drawing Title		PROPOSED SITE PLAN	
HERITAGE WAY GOSPORT		Job-Dwg No	
		15395-110	
Client		MILLGATE GOSPORT DEVELOPMENT LTD	
Status		PLANNING APPLICATION	
Scale	1:500	Drawing Size	A1
Drawn By	JJI	Checked By	JPG
Date	20.02.19		

THE HARRIS PARTNERSHIP MILTON KEYNES  
 The Old Rectory, 79 High Street  
 Newport Pagnell, MK16 8AB  
 T. 01908 211 577 F. 01908 211 722  
 THE HARRIS PARTNERSHIP WAKEFIELD  
 2.51, Johns North, Wakefield, WF1 3QA  
 T. 01924 291 800 F. 01924 290 072  
 THE HARRIS PARTNERSHIP MANCHESTER  
 2nd Floor, Cornhill, Workhouse,  
 77 Dale Street, Manchester, M1 2HG  
 T. 0161 238 8555 F. 0161 244 9809  
 THE HARRIS PARTNERSHIP READING  
 101 London Road, Reading, RG1 5BY  
 T. 0118 956 7700 F. 0118 956 6642

**THE HARRIS PARTNERSHIP**  
 ARCHITECTS  
 www.harrispartnership.com