

STEPHENSON WAY

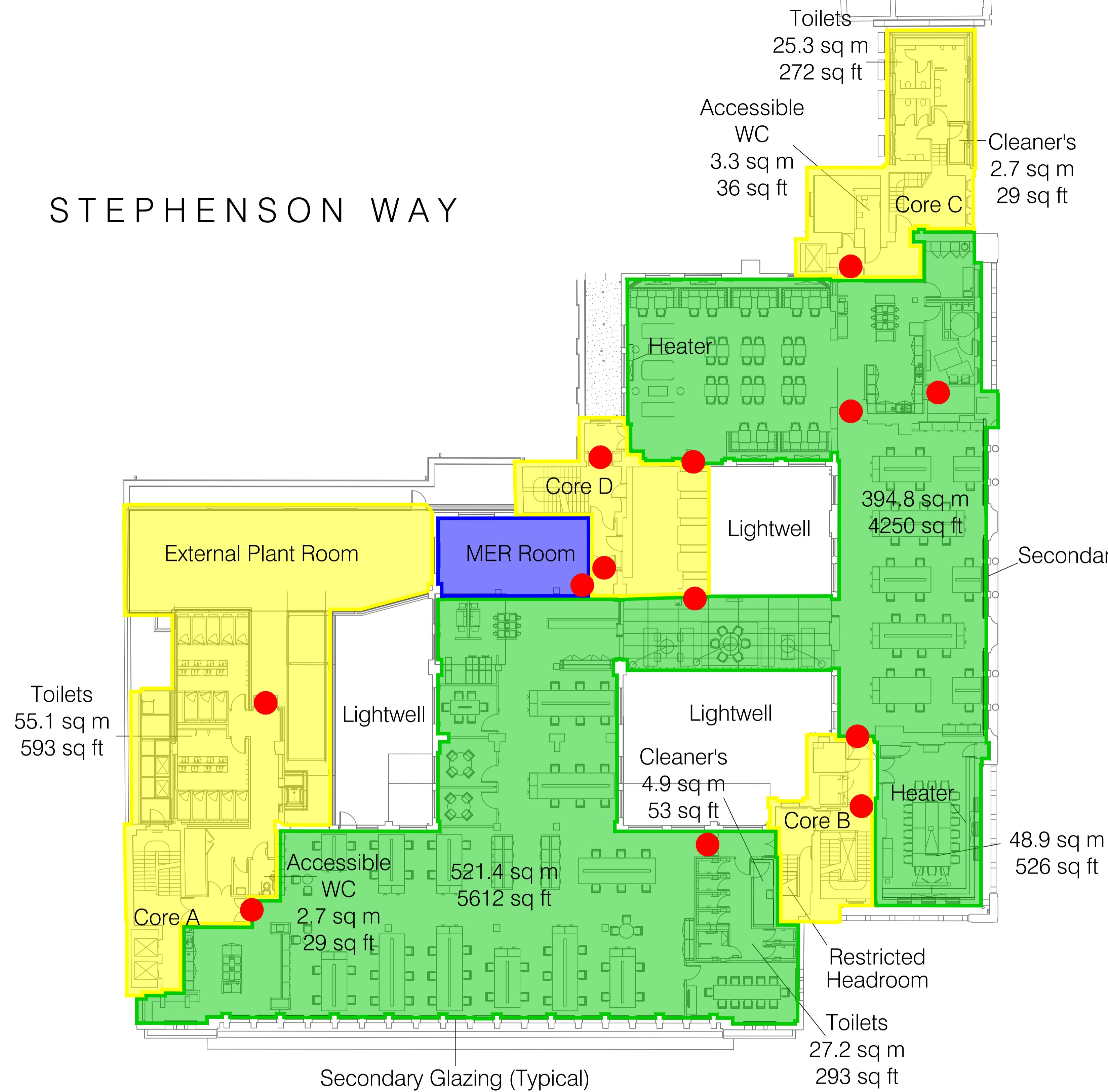

- RCGP – staff/members' (includes: RCGP, EACS, CBRE + Seacys) - 45.2 sq m
- 3rd party tenants (exams, 3rd + 4th floors) - 1122.2 sq m
- Shared / not assessed areas - 597.9 sq m
- Existing access control point

EUSTON ROAD

MELTON STREET

INDIVIDUAL WORKSPACES

DESCRIPTION:	DIMENSIONS:	QUANTITY:
New Workstations	1600x800	XX
120° Workstations	Vary	XX
Existing Workstations	Vary	XX
TOTAL WORKSPACES:		xxx

METRICS

USF:	R/U FACTOR	RSF:	SEATS:	RSF / SEAT:
XXX	XXX	XXX	XXX	XXX

SCALE: not to scale

DRAWN BY: Harmandeep Lally

SUBMISSIONS

DESCRIPTION:	DATE:
Issued for Review - HL	16/03/2023
Revised hatching (For review) - HL	22/03/2023
Existing and new Access control points (For review) - HL	22/03/2023
Amended existing access control points (For review) - HL	23/03/2023

WHOLE FLOOR

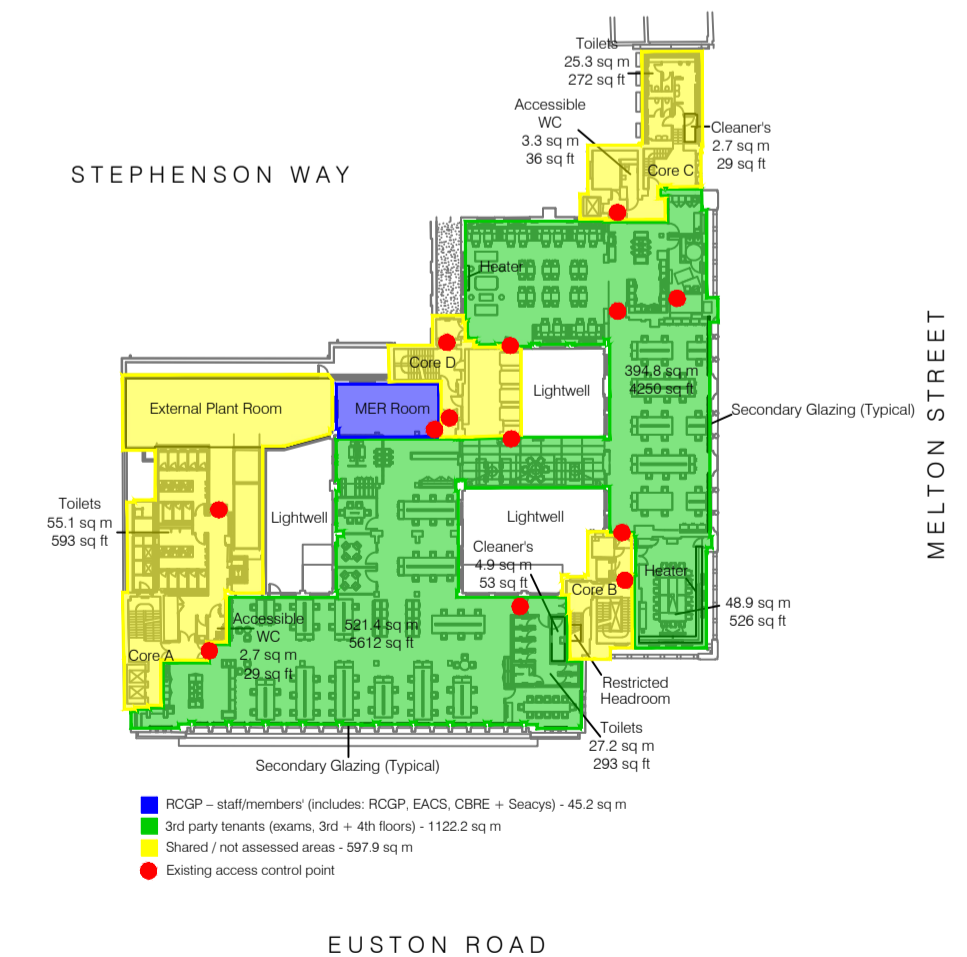

- RCGP – staff/members' (includes: RCGP, EACS, CBRE + Seacys) - 45.2 sq m
- 3rd party tenants (exams, 3rd + 4th floors) - 1122.2 sq m
- Shared / not assessed areas - 597.9 sq m
- Existing access control point

